

AIR RELEASE VALVES

PN 6 | PN 16



Design features

- Automatic, dynamic air release valve
- PE shield for UV protection
- The internal thread inlet is reinforced with a stainless steel ring
- Connection variants: Internal thread or flange
- Insect protective grid (2" valve)
- Installation: upright, preferably at the highest point in the pipeline together with isolating valves
- Air valve for releasing air only: on request (minimum pressure of 0,3 bar needed)

Material | Technical features

DN 1"

Max. air release capacity: 0,13 m³/min.
Test pressure: Body 24 bar
Working pressure: 0,1 - 6 bar
 0,8 - 16 bar

- **Body** made of POM
- **Orifice and valve plug** made of brass
- **Float** made of POM
- **Seal** made of Elastomer
- **UV-shield** made of PE

DN 2" - double acting

Max. air release capacity: 3,2 m³/min.
Test pressure: Body 24 bar
Working pressure: 0,1 - 6 bar
 1 - 16 bar

- **Body and elbow** made of POM
- **Valve seat** made of brass
- **Float** made of POM
- **Seal** made of Elastomer
- **UV-shield** made of PE
- **Insect protective grid** made of stainless steel

No. 9876 DN 1"



No. 9876 DN 2"



No. 9874 DN 2"

Order No.	Version	DN	Working pressure bar
9876	Standard	1"	PN 0,1 - PN 6
			PN 0,8 - PN 16
9876	Standard	2"	PN 0,1 - PN 6
			PN 1 - PN 16
9874	With flange connection DN 50 or DN 80 (ductile iron)	2"	PN 0,1 - PN 6
			PN 1 - PN 16

Automatic air valves are to be maintained according to the usage conditions

AIR RELEASE VALVES

PN 6 | PN 16



DN	MOP (PN)	Working pressure bar	Size of the opening	Ø D	Ø D1	H	Weight
1"	6	0,1 - 6	1,77 mm ²	109	122	172	0,90
	16	0,8 - 16					

Please specify working pressure when ordering

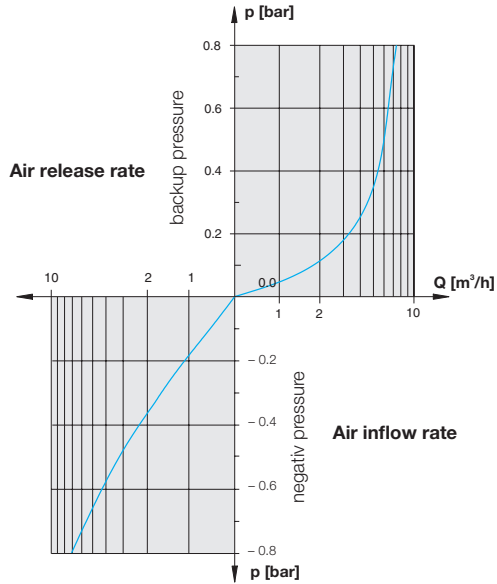

No. 9876 DN 1''

Valve (= wearing part)

No: QA00001600Q013 PN 16

No: QA20001600Q013 PN 6

Replaceable on the spot in depressurised status

- Demount safeguard ring
- Remove cap
- Loosen locking screw
- Valve with valve key unscrew No. 3454

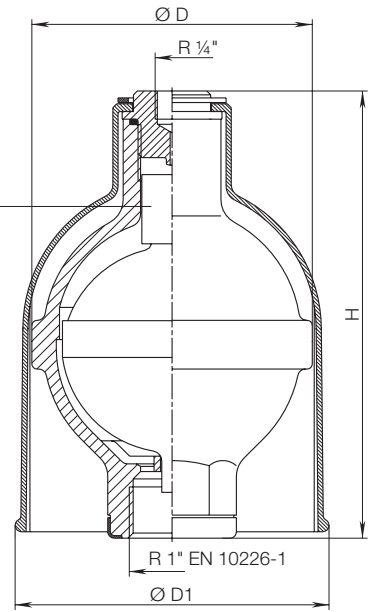

DN	MOP (PN)	Working pressure bar	Size of the opening	Ø A	Ø A1	H	H1	Weight
2"	6	0,1 - 6	900/2 mm ²	160	175	305	320	2,90
	16	1 - 16						3,40

Please specify working pressure when ordering

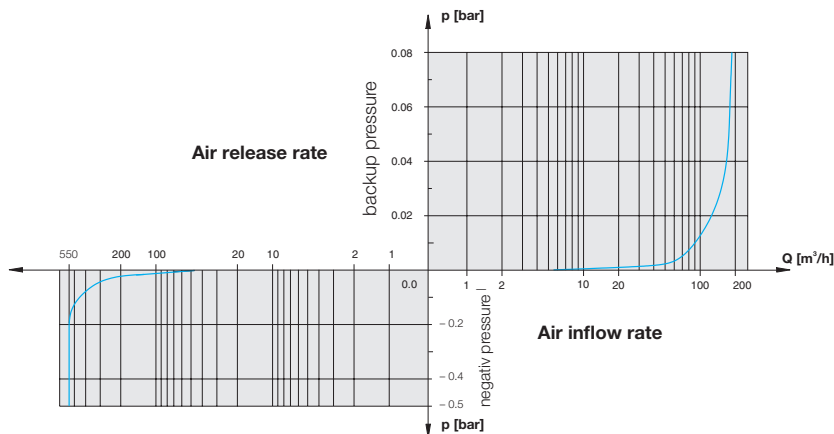

No. 9876 DN 2''

