

E2 VALVE

With flange DN 50-200, PN 10 | PN 16 | PN 25



Design features

- Resilient seated gate valve with smooth straight-through bore
- Flanges sized in accordance with EN 1092-2, drilled according to
EN 1092-2 | PN 10 standard (4000E2, 4700E2);
EN 1092-2 | PN 25 (4010E2, 4710E2)
EN 1092-2 | PN 16 from DN 200 (4000E2, 4700E2)
Please specify on order - other standards on request
- Suitable for cleaning with a cleaning pig
- One extension spindle for several dimensions
- Suitable for operation by automatic actuators
- Easy refitting for position indicator and automatic actuators on the standard bonnet
- Duplex stainless steel spindle

Standard version: without handwheel and extension spindle

Design versions: for actuator: No. 4000ELE2
with position indicator: No. 4000STE2
for seawater: No. 4002E2, No. 4702E2

Special versions: on request

Suitable accessories

Suitable accessories: see page A 1/2

Handwheel: No. 7800
Extension spindles: rigid No. 9000E2
telescopic No. 9500E2
Surface boxes: rigid No. 1750
telescopic No. 2050
No. 2051K
No. 9920
Valve actuator: No. 8630E2
Adapter for actuator (E2 adapter): No. 8630E2
Base plate: No. 3481, No. 3482
Operating cap: No. 2156, No. 2157, No. 2158
Extension spindle: No. 7820, No. 7825
Position indicator: No. 2170E2
Bolts: No. 8810, No. 8830, No. 8840
HAWAK-pillar: No. 9894, No. 9895
Flat gasket: No. 3390, No. 3470

No. 4000E2
No. 4700E2
No. 4010E2
No. 4710E2
No. 4060E2



Order no.	Version	MOP (PN)	Dimensions/DN						
			50	65	80	100	125	150	200
4000E2	short	16							
	EN 558-1 GR 14								
4700E2	long	16							
	EN 558-1 GR 15								
4010E2	short	25							
	EN 558-1 GR 14								
4710E2	long	25							
	EN 558-1 GR 15								
4060E2	to BS 5163	16							

Application example



E2 VALVE

With flange DN 50-200, PN 10 | PN 16 | PN 25



No. 4000E2
 No. 4700E2
 No. 4010E2
 No. 4710E2
 No. 4060E2

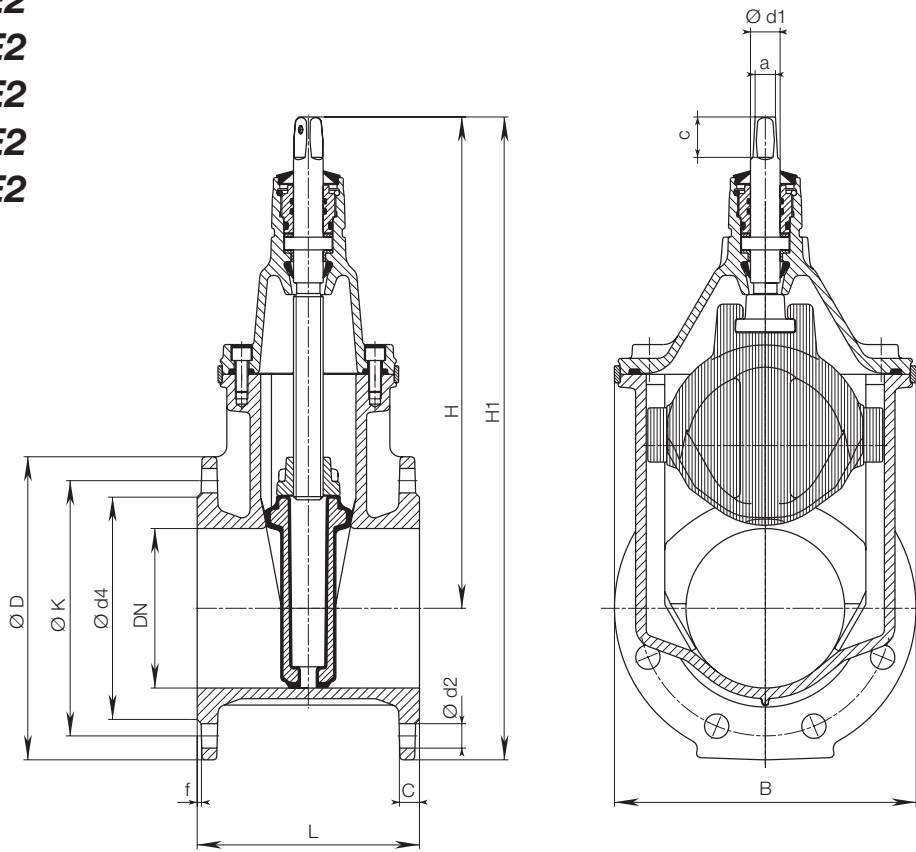

DN	MOP (PN)	Flange					Bolts			Spindle			Valve					Weight			
		$\varnothing D$	C	$\varnothing K$	$\varnothing d4$	f	Qty.	Thread	$\varnothing d2$	a	c	$\varnothing d1$	H	H1	L short	L long	BS 5163	B	short	long	BS 5163
50	10																				
	16	165	19	125	98	3	4	M 16	19	14,8	30	22	260	342	150	250		143	11,0	12,0	
	25																		11,0		
65	10																				
	16	185	19	145	118	3	4	M 16	19	17,3	35	25	328	420	170	270		180	17,0	18,0	
	25						8												17,0		
80	10																				
	16	200	19	160	133	3	8	M 16	19	17,3	35	25	336	436	180	280	203	180	18,5	20,5	19,0
	25																		18,5		
100	10																				
	16	220	19	180	153	3	8	M 16	19	19,3	38	25	373	483	190	300	229	213	24,5	27,5	26,0
	25	235		190				M 20	23					480					24,5		
125	10																				
	16	250	19	210	183	3	8	M 16	19	19,3	38	28	450	575	200	325		285	35,5	38,0	
	25	270		220				M 24	28										35,0		
150	10																				
	16	285	19	240	209	3	8	M 20	23	19,3	38	28	462	605	210	350	267	285	40,5	46,0	45,0
	25	300		250				M 24	28										40,5	49,0	
200	10						8														
	16	340	20	295	264	3	12	M 20	23	24,3	48	32	563	733	230	400	292	357	64,0	72,0	67,5
	25	360		310			12	M 24	28					743					64,0	81,0	