

HAWLE-A VALVE

With flange DN 50-300, PN 10 | PN 16



Design features

- Resilient seated gate valve with smooth straight bore
- Flanges sized in accordance with EN 1092-2, drilled according to EN 1092-2 | PN 10 standard; EN 1092-2 | PN 16 for DN 200 to DN 300. Please specify on order - other standards on request
- Suitable for cleaning with a cleaning pig
- One extension spindle for several dimensions

Standard version: without handwheel and extension spindle (Suitable only for manual actuation)

Design versions: short or long face-to-face length, closing clockwise or anti-clockwise

Suitable accessories

Suitable accessories: see page A 1/2

Handwheel:		No. 7800
Extension spindles:	rigid	No. 9000A
	telescopic	No. 9500A
Surface boxes:	rigid	No. 1750
	telescopic	No. 2050 No. 2051K
Base plate:		No. 3481, No. 3482
Operating cap:		No. 2156, No. 2157, No. 2158
Extension spindle:		No. 7820, No. 7825
Bolts:		No. 8810, No. 8830, No. 8840
HAWAK-pillar:		No. 9894, No. 9895
Flat gasket:		No. 3390, No. 3470

No. 4000A

No. 4700A

No. 4288A



Order no.	Version	MOP (PN)	Dimensions/DN											
			50	65	80	100	125	150	200	250	300			
4000A	short EN 558-1 GR 14	16												
4700A	long EN 558-1 GR 15													
4288A	CSN 133045													

HAWLE-A VALVE

With flange DN 50-300, PN 10 | PN 16



DN 50 / DN 65

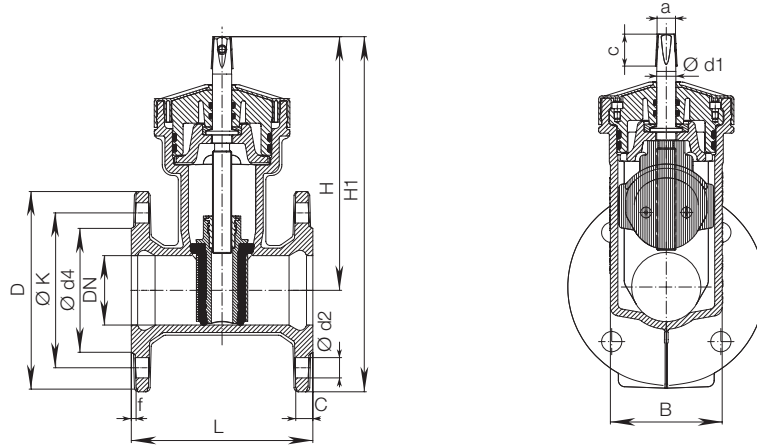

DN 80 – DN 300

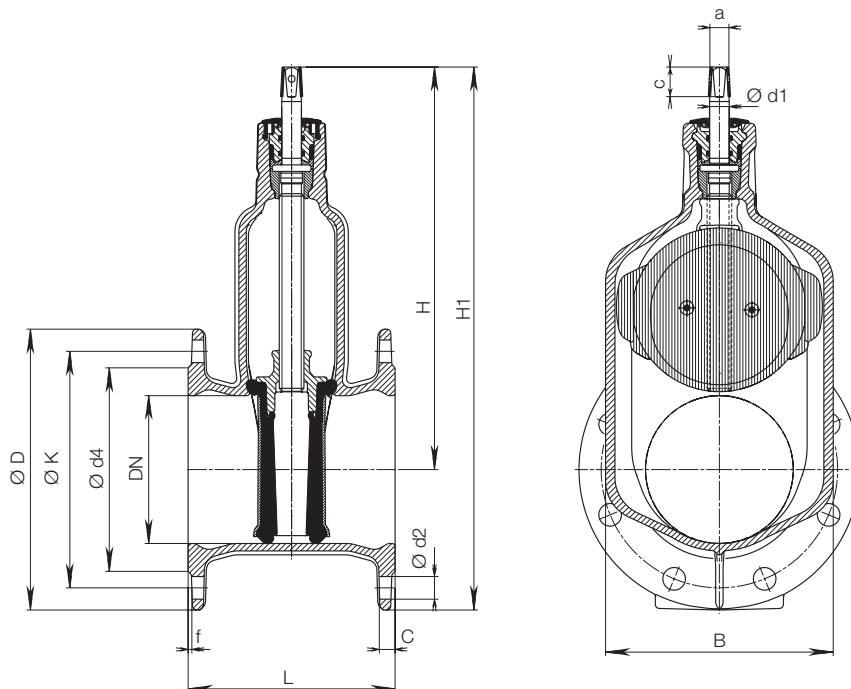

DN	MOP (PN)	Flange					Bolts		Spindle			Valve						Weight			
		ØD	C	ØK	Ød4	f	Qty.	Thread	Ød2	a	c	Ød1	H	H1	L short	L long	L CSN	B	short	long	CSN
50	10	165	16	125	96	4,5	4	M 16	19	14,8	30	18	230	315	150	250	180	105	8,2	9,0	8,6
	16																				
65	10	185	16	145	116	4,5	4	M 16	19	17,3	30	18	238	333	170	270		105	9,4	10,5	
	16																				
80	10	200	16	160	133	4	4	M 16	19	17,3	30	20	286	386	180	280	210	136	10,5	12,8	11,9
	16																				
100	10	220	16	180	153	4	8	M 16	19	19,3	30	20	317	427	190	300	230	158	15,0	16,3	15,5
	16																				
125	10	250	16	210	183	4,5	8	M 16	19	19,3	30	20	359	485	200	325		207	19,0	21,8	
	16																				
150	10	285	16	240	207	4	8	M 20	23	19,3	30	20	409	552	210	350	280	231	26,5	30,0	27,7
	16																				
200	10	340	17	295	264	4	8	M 20	23	24,3	38	25	509	679	230	400	330	282	41,2	46,5	44,2
	16																				
250	10	400	22	350	319	4	12	M 20	22,4	27,3	38	32	599	799	250			410	88,7		
	16																				
300	10	455	23,5	400	369	6	12	M 20	22,4	27,3	38	32	674	901	270			470	118,6		
	16																				