

SMART JOINT

SMART SERIES FLANGE ADAPTORS

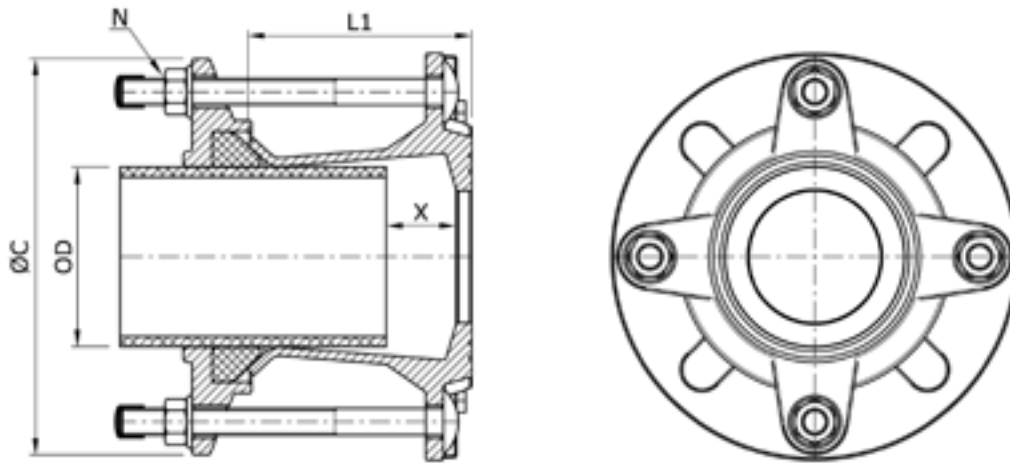

| DN | ØD | | L1 | ØC | Bolts Quantity | Gap X | | Type Of Flange | Weight | |
|---------|------|------|-----|---------|-------------------|-------|------|-------------------|--------|------|
| | Min. | Max. | | | | Max | Min. | | | |
| 50 | 58 | 74 | 170 | 170 | 4 | 70 | 40 | a,b,c,d | 3,9 | |
| 50/65 | 68 | 84 | | 183 | | | | a,b,c,d | 4,5 | |
| 80 | 84 | 105 | | 210 | | | | a,b,c,d | 5,2 | |
| 100 | 99 | 118 | | 223 | | | | a,b,c,d | 5,9 | |
| | 109 | 133 | 244 | a,b,c,d | 6,5 | | | | | |
| 125/150 | 133 | 157 | 190 | 268 | 6 | 80 | 35 | a,b,c,d | 8,4 | |
| 150 | 157 | 182 | | 296 | | | | a,b,d | 10 | |
| 200 | 194 | 215 | | 322 | | | 20 | a,b,d | 12 | |
| | 218 | 242 | | 354 | | | | 35 | a,b | 14,4 |
| 250 | 242 | 268 | | 403 | | | 35 | | a,b | 17,4 |
| | 266 | 291 | | 405 | | | | | a,b | 17,8 |
| | 280 | 305 | 424 | a,b | 21 | | | | | |
| 300 | 302 | 327 | 443 | a,b,d | 23,7 | | | | | |

The data concerning the min. and max. gap is calculated on the minimum outside diameter of the product's range

FOR FLANGED VERSION

- a. EN1092 PN10, PN16
- b. ANSI B16. CL125
- c. BS 10 TABLE D
- d. BS 10 TABLE E

NOTES

